



MY DOMAIN
STUDENT LIVING

RENTAL APPLICATION

1 LOWER CHURCH STREET, WYNBERG, 7800

+27 (0)71 679 0208 | +27 (0)83 541 7845 | +27 (0)21 447 7244 | wynberg@mydomainliving.co.za

Preferred date of occupation: ____ / ____ / ____

DETAILS OF THE LEASEHOLDER TO RENT THE PREMISES (Person responsible for Monthly Rental)

Full name

ID no. (copy to be attached); OR

Passport no. (copy to be attached)

Date of birth

Nationality

Telephone (home)

Telephone (mobile)

Telephone (work)

Fax number

Email address

Address where you currently stay

Marital status

If married (please tick appropriately)

In community of property

ANC

Accrual System

*Residents receiving bursaries or private funding are required to provide these details under leaseholder information.

REQUIRED SUPPORTING DOCUMENTS TO BE ATTACHED WITH THIS APPLICATION

- Leaseholder ID Document / Passport / Company Documents
- Resident's ID Document / Passport
- Leaseholder's proof of current address
- Resident's study permit (international students only)
- Leaseholder's pay slip and / or 3 month's bank statements / Company Bank statements
- Resident's acceptance letter from academic institution (can be provided upon receipt from institution)
- Proof of funding / Letter of surety (applicable to residents receiving bursaries & alternative private funding)

ARE YOU THE OWNER OF THE PROPERTY WHERE YOU CURRENTLY STAY?

Yes

No

If no, please provide us with the following:

How long have you rented there

Monthly rental amount

Name of Rental Agent / Landlord

Work & mobile number

DETAILS OF THE LEASEHOLDER TO RENT THE PREMISES (Person responsible for Monthly Rental)

Self-employed

Yes

No

Occupation

If employed, name company

Employer's name

Employer's telephone number

Employer's email address

Gross monthly salary before deductions
(tax copy of pay slip to be attached)

Current monthly expenses

DETAILS OF THE RESIDENT APPLYING TO OCCUPY THE UNIT

Full name

ID no. (copy to be attached); OR

Passport no. (copy to be attached)

Date of birth

Nationality

Telephone (mobile)

Email address

Address where you currently stay

Name of Rental Agent / Landlord

Work & mobile number

Where will you be studying

What year of study will you be in

What City are you from

What School did you attend

What is your gender

DETAILS OF THE PREMISES

STUDIO (ONLY 1 PERSON MAY OCCUPY THE ROOM)

Open plan studio with single bed base & mattress, desk, wardrobe, a kitchenette with induction plate & mini-refrigerator, and bathroom pod (shower, basin & toilet). Water & electricity* are included, access to facilities and recreational areas, and free uncapped WIFI.

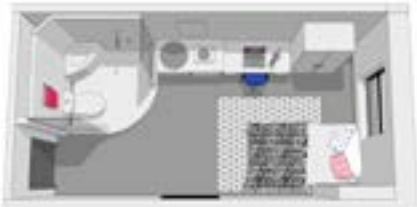

12 Months

Rental – R4 600.00 per month
Deposit – R9 200.00 once-off
(R4 600.00 as security deposit
R4 600.00 as damage deposit)

Select :

10 Months

Rental – R5 500.00 per month
Deposit – R11 000.00 once-off
(R5 500.00 as security deposit
R5 500.00 as damage deposit)

Select :

CLASSIC STUDIO (ONLY 1 PERSON MAY OCCUPY THE ROOM)

Open plan studio with 3/4 bed base & mattress, desk, wardrobe, a kitchenette with induction plate & mini-refrigerator, and bathroom pod (shower, basin & toilet). Water & electricity* are included, access to facilities and recreational areas, and free uncapped WIFI.



12 Months

Rental – R4 800.00 per month
Deposit – R9 600.00 once-off
(R4 800.00 as security deposit
R4 800.00 as damage deposit)

Select :

10 Months

Rental – R5 800.00 per month
Deposit – R11 600.00 once-off
(R5 800.00 as security deposit
R5 800.00 as damage deposit)

Select :

PREMIUM STUDIO (ONLY 1 PERSON MAY OCCUPY THE ROOM)

Open plan studio with double bed base & mattress, desk, wardrobe, a kitchenette with induction plate & mini-refrigerator, and bathroom pod (shower, basin & toilet). Water & electricity* and a 10 channel DSTV bouquet are included, access to facilities and recreational areas, and free uncapped WIFI.



12 Months

Rental – R5 600.00 per month
Deposit – R11 200.00 once-off
(R5 600.00 as security deposit
R5 600.00 as damage deposit)

Select :

10 Months

Rental – R6 500.00 per month
Deposit – R13 000.00 once-off
(R6 500.00 as security deposit
R6 500.00 as damage deposit)

Select :

DELUXE STUDIO (ONLY 1 PERSON MAY OCCUPY THE ROOM)

Open plan, spacious studio with double bed base & mattress, desk, wardrobe, a kitchenette with induction plate & mini-refrigerator, and conventional bathroom (shower, basin & toilet). Water & electricity* and a 10 channel DSTV bouquet are included, access to facilities and recreational areas, and free uncapped WIFI.



12 Months

Rental – R6 150.00 per month
Deposit – R12 300.00 once-off
(R6 150.00 as security deposit
R6 150.00 as damage deposit)

Select :

10 Months

Rental – R6 700.00 per month
Deposit – R13 400.00 once-off
(R6 700.00 as security deposit
R6 700.00 as damage deposit)

Select :

CHALET STUDIO (ONLY 1 PERSON MAY OCCUPY THE ROOM)

Open plan, spacious studio with double bed base & mattress, side table & lamp, couch, desk & chair, wardrobe, a kitchenette with induction plate & mini-refrigerator, and conventional bathroom (shower, basin & toilet). Water & electricity* and a 10 channel DSTV bouquet are included, access to facilities and recreational areas, and free uncapped WIFI.



12 Months

Rental – R7 000.00 per month
Deposit – R14 000.00 once-off
(R7 000.00 as security deposit
R7 000.00 as damage deposit)

Select :

10 Months

Rental – R7 500.00 per month
Deposit – R15 000.00 once-off
(R7 500.00 as security deposit
R7 500.00 as damage deposit)

Select :

TWIN STUDIO (2 PEOPLE MAY OCCUPY THE ROOM)

Open plan studio with 2 single bed base & mattresses, 2 desks, 2 wardrobes, a kitchenette with induction plate & mini-refrigerator, and conventional bathroom (shower, basin & toilet). Water & electricity* are included, access to facilities and recreational areas, and free uncapped WIFI.



12 Months

Rental – R7 000.00 per month
Deposit – R14 000.00 once-off
(R7 000.00 as security deposit
R7 000.00 as damage deposit)

Select :

10 Months

Rental – R9 500.00 per month
Deposit – R19 000.00 once-off
(R9 500.00 as security deposit
R9 500.00 as damage deposit)

Select :

2 BEDROOM UNIT (2 PEOPLE MAY OCCUPY THE UNIT, EACH WITH THEIR OWN BEDROOM)

A 2 bedroom apartment with shared living area - each room is furnished with a double bed & mattress, desk & wardrobe, the living area has a kitchenette with induction plate & mini-refrigerator, and conventional bathroom (shower, basin & toilet). Water & electricity* are included, access to facilities and recreational areas, and free uncapped WIFI.

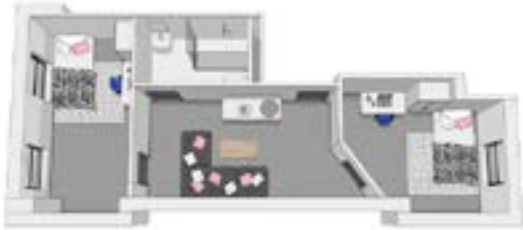

12 Months

Rental – R7 700.00 per month
Deposit - R15 400.00 once-off
(R7 700.00 as security deposit
R7 700.00 as damage deposit)

Select :

10 Months

Rental – R8 600.00 per month
Deposit - R17 200.00 once-off
(R8 600.00 as security deposit
R8 600.00 as damage deposit)

Select :

When applying for a 2 bedroom, students are required to find an additional resident to share the unit with. Each resident is required to complete and submit an application.

OPTIONAL EXTRAS

Motor vehicle parking bay

(Additional cost of R300.00 per month)

Motorcycle parking bay

(Additional cost of R150.00 per month)

10 Channel DSTV bouquet

(Additional cost of R150.00 per month, R750.00 once-off activation fee & TV not included)

Storeroom

(Additional cost of R400.00 per month)

GENERAL DETAILS

Have you (leaseholder) ever had any judgments / defaults granted against you? (A judgment is a court order requested by your credit provider when you have not paid your debt)

Yes

No

If yes, please provide details: _____

DECLARATION

I / we declare that the information we have given in this application form is true and correct to the best of my / our knowledge and that I / we have not failed to provide any information which, if the Landlord had known such information, would have not allowed the application to be successful.

I / we agree and allow the Landlord or Agent at all times to:

1. contact, request and obtain information from any credit provider (or potential credit provider) or registered credit bureau that may be necessary to assess my / our behavior, profile, payment patterns, indebtedness, whereabouts, and creditworthiness;
2. provide information concerning the behavior, profile, payment patterns, indebtedness, whereabouts, and creditworthiness of me / us to any registered credit bureau or to any credit provider (or potential credit provider) seeking a trade reference regarding my / our dealings with the Landlord.

Signed by the Leaseholder at (place) _____ on this the _____ day of _____ 20 _____

LEASEHOLDER

IMPORTANT INFORMATION

- Submit your completed electronic application form & support documents to wynberg@mydomainliving.co.za
- The application fee is R1 000.00 ex VAT.
- The deposit is payable within 48 hours from receipt of invoice and unit allocation.
- Unit allocation is subject to availability.
- A lease agreement will be sent once payment has been received.
- The 1st month's rental (and pro-rata rental if applicable) is payable before occupation.
- *Electricity & water charges are included in the monthly rental amount, according to fair usage policy.